

MAIN LEVEL

Floor Area: 538 Sq. Ft.
Ceiling Height: 10'3"

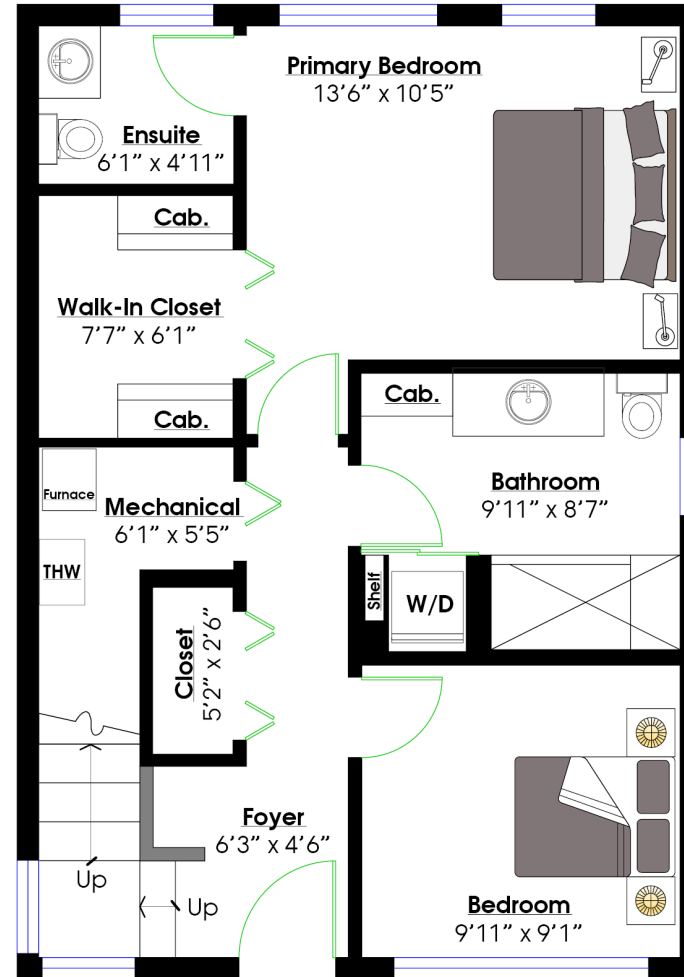

LOWER LEVEL

Floor Area: 644 Sq. Ft.
Ceiling Height: 8'

SQ/FT TOTALS **

Main Level:	538 sq/ft
Lower Level:	644 sq/ft
TOTAL:	1,182 sq/ft
Deck	151 sq/ft

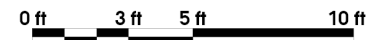

Layout by BC Floorplans. ** While all reasonable attempts have been made to ensure accuracy and the square footage and room dimensions are believed to be correct to ANSI Standards, due to the possibility of human error the information cannot be guaranteed. EGO Insured for \$1,000,000. Information should not be relied upon without independent verification.