

SQ/FT TOTALS **

Main Level:	965 sq/ft	Deck:	103 sq/ft
Lower Level:	729 sq/ft	Primary Deck:	178 sq/ft
TOTAL:	1,694 sq/ft	Carport:	510 sq/ft

MAIN LEVEL
Floor Area: 965 Sq. Ft.
Ceiling Height: 8'

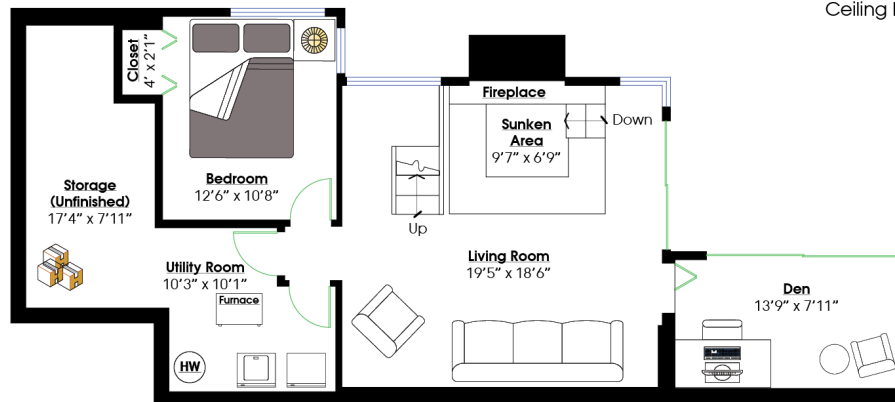

LOWER LEVEL
Floor Area: 729 Sq. Ft.
Ceiling Height: 8'5"



0 ft 3 ft 5 ft 10 ft

Layout by BC Floorplans. ** While all reasonable attempts have been made to ensure accuracy and the square footage and room dimensions are believed to be correct to ANSI Standards, due to the possibility of human error the information cannot be guaranteed. EGO Insured for \$1,000,000. Information should not be relied upon without independent verification.