



For more information
 Call **604 983 2518** or visit
RealEstateNorthShore.com

2501 PANORAMA DRIVE

Deep Cove, North Vancouver

SQ/FT TOTALS

Main Level: 822 sq/ft
 Below Main: 1,131 sq/ft
 Lower Level: 369 sq/ft
 Total: 2,322 sq/ft

Patio: 185 sq/ft
 Deck: 168 sq/ft
 Porch: 22 sq/ft

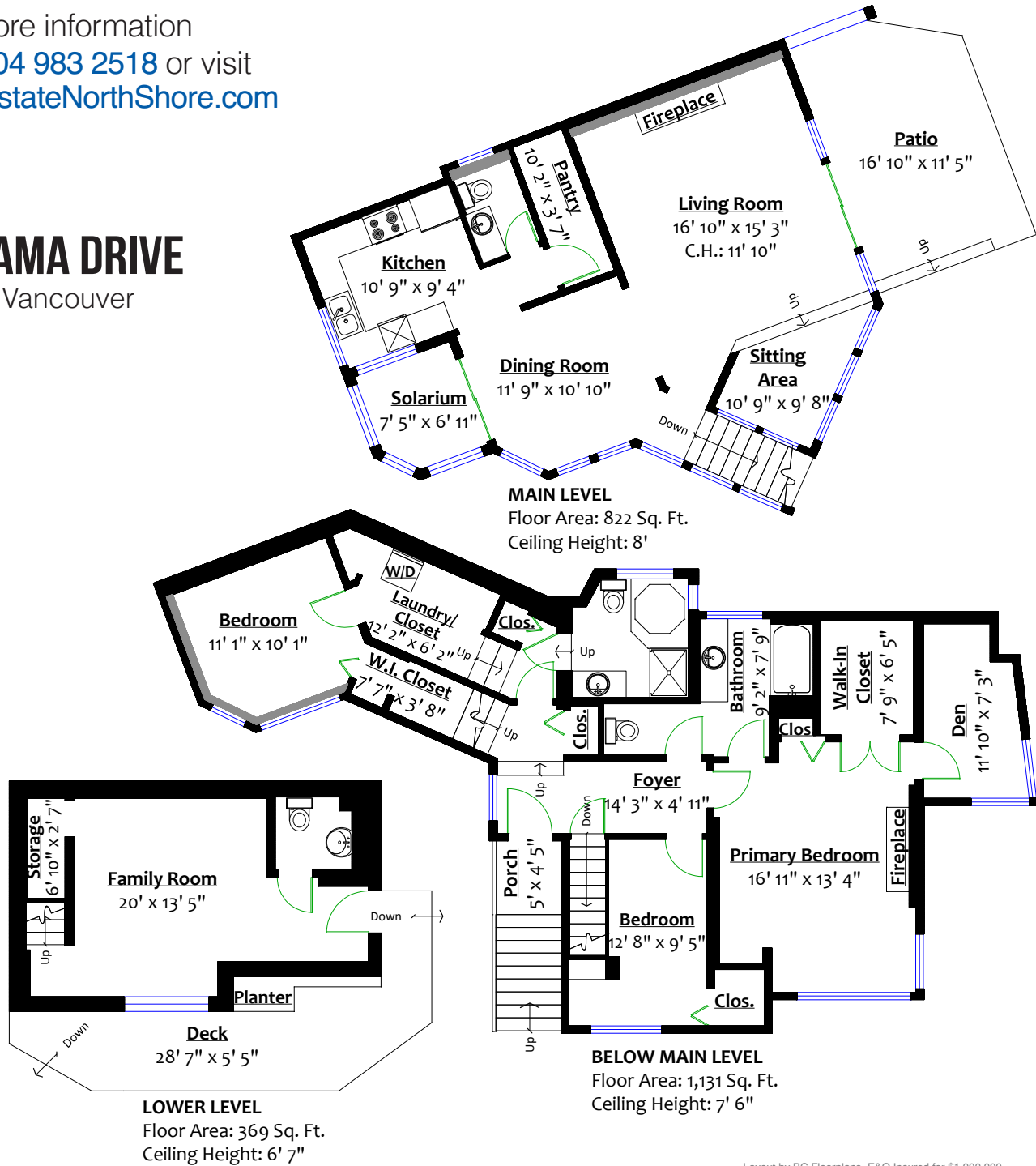

Layout by BC Floorplans. E&O Insured for \$1,000,000
 While all reasonable attempts have been made to ensure accuracy and the square footage and room dimensions are believed to be correct to ANSI Standards, due to the possibility of human error the information cannot be guaranteed. Information should not be relied upon without independent verification.
 This communication is not intended to cause or induce breach of an existing agency agreement.