

1182 RONAYNE ROAD

Lynn Valley, North Vancouver

Bill Mason
604.290.4975
Re/Max Crest Realty

Rossetti Team
604.983.2518
Re/Max Rossetti Realty



SQ/FT TOTALS

Main Level:	1,441 sq/ft	Porch:	30 sq/ft
Lower Level:	1,423 sq/ft	Deck:	235 sq/ft
Total:	2,864 sq/ft	Side Deck:	113 sq/ft
		Carport:	160 sq/ft

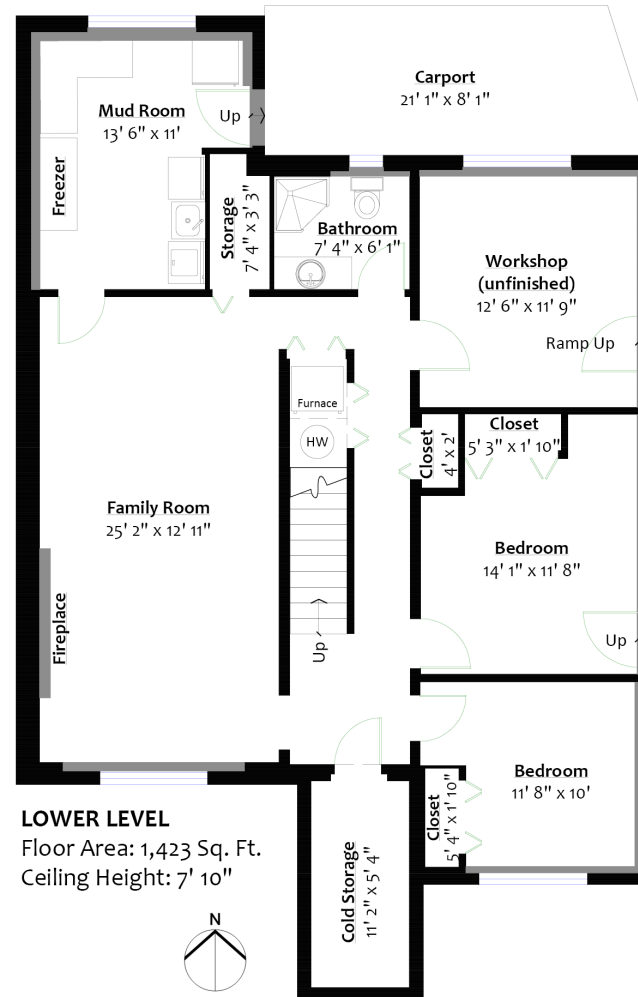

Layout by BC Floorplans. E&O Insured for \$1,000,000
While all reasonable attempts have been made to ensure accuracy and the square footage and room dimensions are believed to be correct to ANSI Standards, due to the possibility of human error the information cannot be guaranteed. Information should not be relied upon without independent verification.
This communication is not intended to cause or induce breach of an existing agency agreement.