

4188 COVENTRY WAY

Upper Lonsdale, North Vancouver

MEASUREMENTS

INTERIOR

Main Level: 1,541 sq/ft
 Upper Level: 1,312 sq/ft
 Lower Level: 1,219 sq/ft
 Grand Total: 4,072 sq/ft

EXTERIOR

Deck: 594 sq/ft
 Patio: 1,040 sq/ft
 Master Deck: 72 sq/ft
 Upper Deck: 59 sq/ft
 Garage: 633 sq/ft

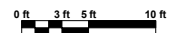
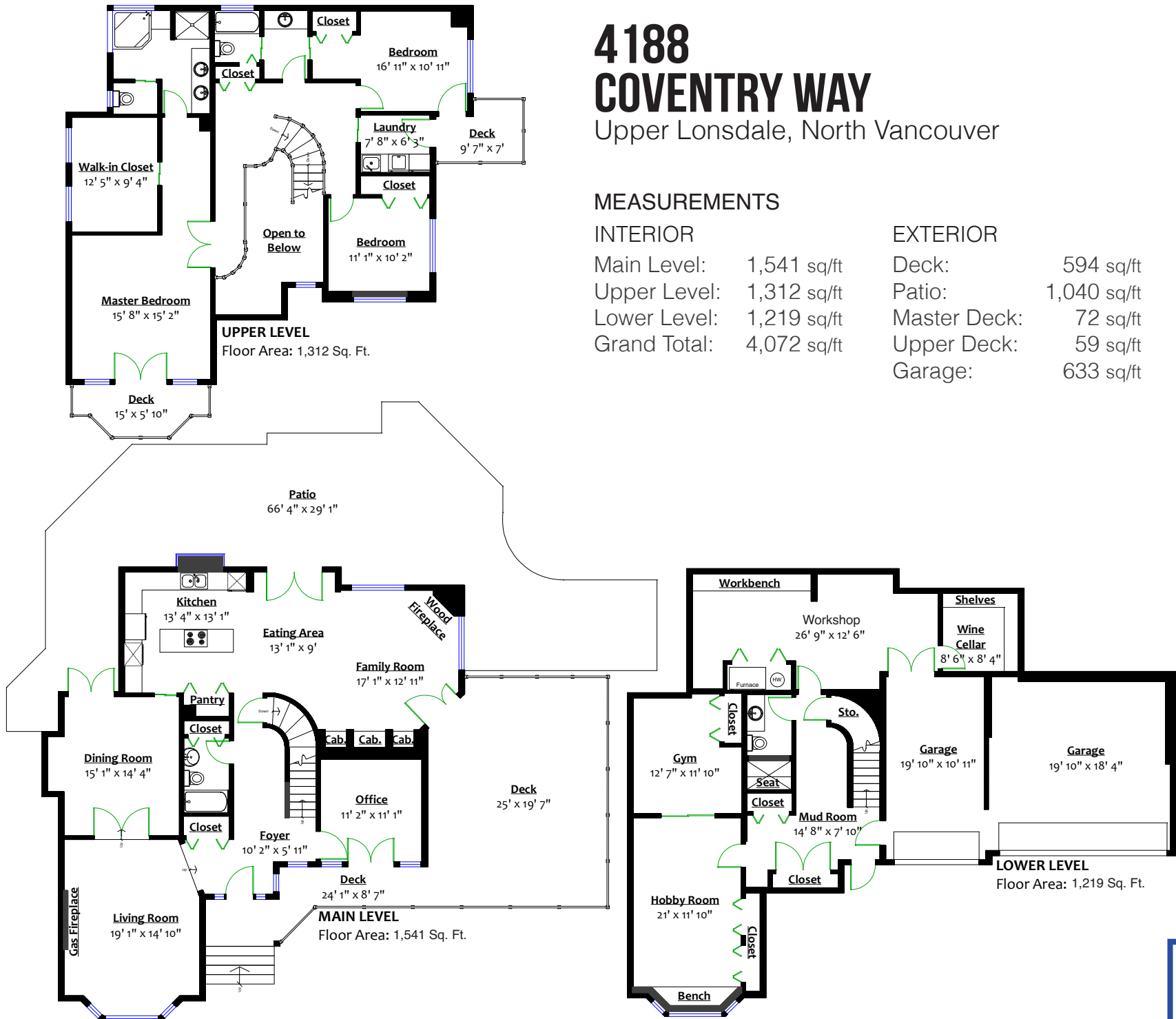

* Square footage is approximate based on interior measurements to exterior walls. BC Floorplans. This communication is not intended to cause or induce breach of an existing agency agreement.